

Entryphone® 53#V Operating Instructions

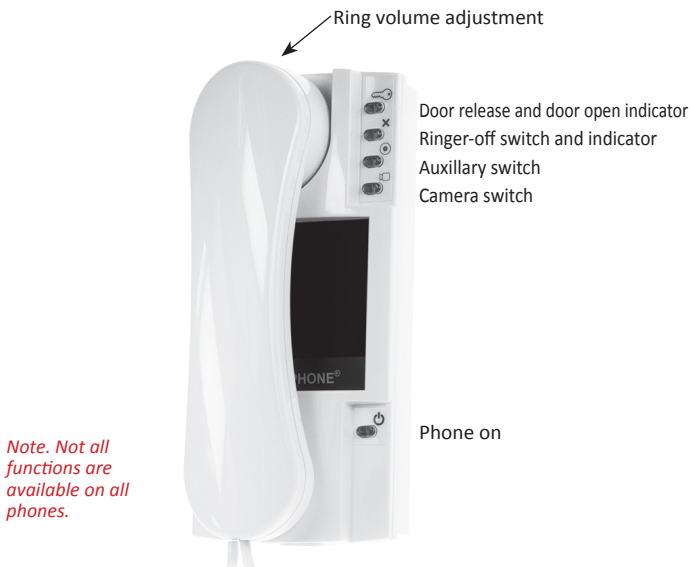

The Entryphone 53#V is a wall-mounted, colour video telephone. The video screen and the speech circuits turn on automatically when the telephone is called. If you wish to speak to the caller, lift the handset and talk to a caller as you would on any telephone.

If you wish to admit a visitor, press the door release button on the upper right of the unit. Note: the release button will only operate when the screen is on.

The unit will turn itself off either a short time after the door has been released or after about ninety seconds of operation.

The function switches (if fitted).

Door release button and indicator: If you wish to admit a visitor, press the door release button on the upper right of the unit. Note: The release button will only operate when the screen is on. If the lock release is fitted with a monitor switch the release button will illuminate to indicate that the door is open.

Ringer off switch and indicator: Press the ringer-off switch to mute the ringer; the button will illuminate to indicate the ringer is muted, press again to cancel.

Camera Switch: If your system has a second camera fitted press this to switch between cameras or lock the view to one camera.

Phone on and power indicator: If the phone has not been called you can use this button to turn the phone on, the indicator will illuminate. The unit will turn itself off either a short time after the door has been released or after about ninety seconds of operation.

Ring Volume: On the top left of the telephone there is a ring volume adjustment that can be turned using a small screwdriver. Turn clock-wise to increase the volume.