

# CISA® Electric Lock



## CISA® Lock

The CISA lock differs from the latch/release arrangement in that the moving parts of the releasing mechanism are in the lock itself and not in the keep, which is fixed in the same way as a conventional lock keep.

The CISA lock gives two particular advantages over a standard release: It is stronger than a conventional release and is not prone to being slipped (i.e. using a piece of plastic to force back the tongue of the lock).

However, the following should be considered:

**Noise.** The CISA lock requires more current to operate it than a standard release as its solenoid needs more power to release its mechanism. Therefore when it is operated the solenoid is relatively noisy and the "clack" of the lock withdrawing is also comparatively loud.

**Momentary action.** Once the CISA lock has been operated, either electrically or locally (using the button on the casing), the lock will remain unlocked until the door has been opened and re-closed; it is the action of the door being closed that sets the device. If the device is operated accidentally this will mean the lock will remain open until the next time the door is opened and re-closed.



**Part No. Description**

- CISA-LH Left handed electric lock - standard device for inward opening wooden doors (illustrated).
- CISA-RH Right handed electric lock - standard device for inward opening wooden doors.



**Part No. Description**

- CISA-G-LH Left handed electric lock with galvanised case suitable for external use on inward opening doors or gates.
- CISA-G-RH Right handed electric lock with galvanised case suitable for external use on inward opening doors or gates (illustrated).

**Wiring**

As the electrical components are in the lock itself the wiring for the CISA has to be run across the hinge of the door (using a door loop) and then across the door itself. Wiring to the lock can be rather obtrusive. It is possible, however, to conceal the wiring but this may involve removing architraves and routing the edge of the door.

Drawing shows right handed CISA lock fitted to a single wooden door with door loop and typical wiring route.

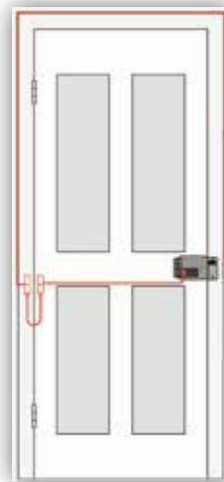

**Handing**

The CISA lock differs depending on which side of a door it is to be fitted. It is important to specify whether a left or right handed lock is required.

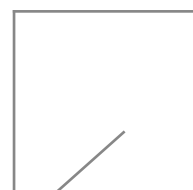

Left Hand

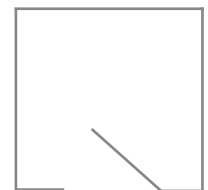

Right Hand