

# Entryphone 201V Operating Instructions

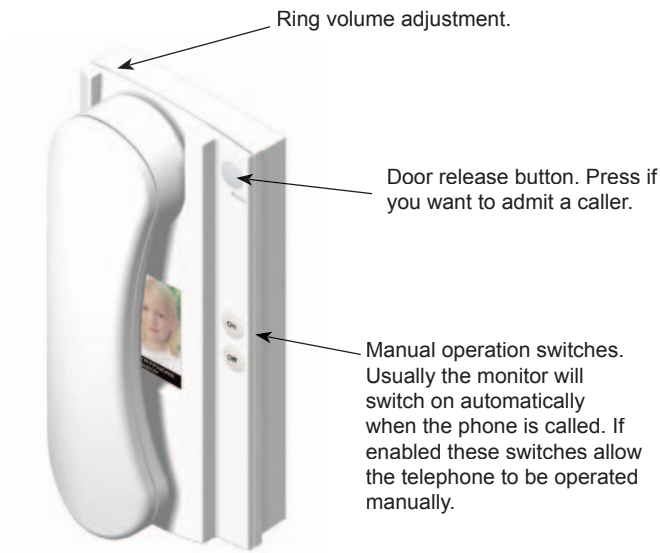

**The Entryphone 200V is a wall mounted, colour video, telephone. There are three buttons, the button at the top right operates the door release and the lower "On" and "Off" buttons allow manual operation of the monitor.**

**Automatic operation:** The video screen and the speech circuits turn on automatically when the telephone is called. If you wish to speak to the caller lift the handset and talk to a caller as you would on any normal telephone.

If you wish to admit a visitor press the small release button on the upper right of the unit. Note: The release button will only operate when the screen is on.

**Manual Operation:** On and off switches are provided so the unit can be operated manually (these may be disabled on some systems).

**Ring Volume:** On the top left of telephone there is a ring volume adjustment that can be turned using a small screwdriver. Turn clock-wise to increase the volume.