

Entryphone 200V4 Operating Instructions

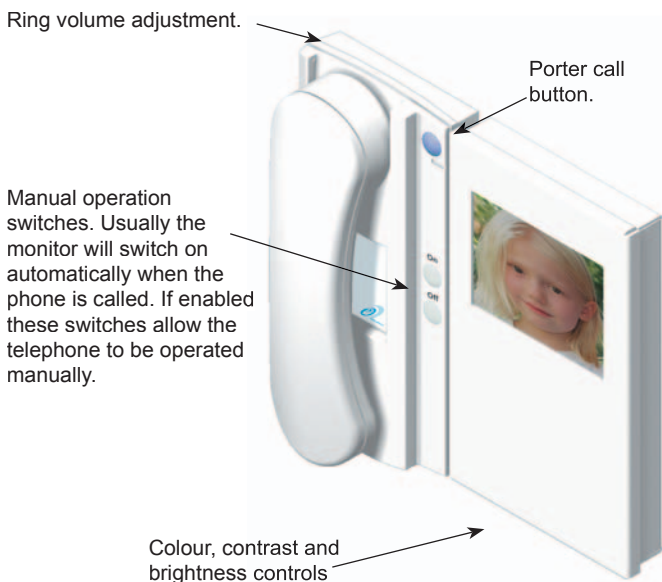

The Entryphone 200V4 is a wall mounted, colour video monitor telephone. There are three buttons, on the telephone, the button at the top calls the porter and the lower “On” and “Off” buttons allow manual operation of the monitor.

Automatic operation: The video screen and the speech circuits turn on automatically when the telephone is called. If you wish to answer a call lift the handset and talk to the caller as you would on any normal telephone.

Manual Operation: On and off switches are provided so the unit can be operated manually (these may be disabled on some systems).

Ring Volume: On the top left of telephone there is a ring volume adjustment that can be turned using a small screwdriver. Turn clock-wise to increase the volume.

Screen Controls: On the bottom face of the monitor are three control wheels for adjusting colour, contrast and brightness.